

# Auto-Adjust® II Turbo-Meters 12" AAT-140 and 12" AAT-230

## Parts List

THE GAS INDUSTRY

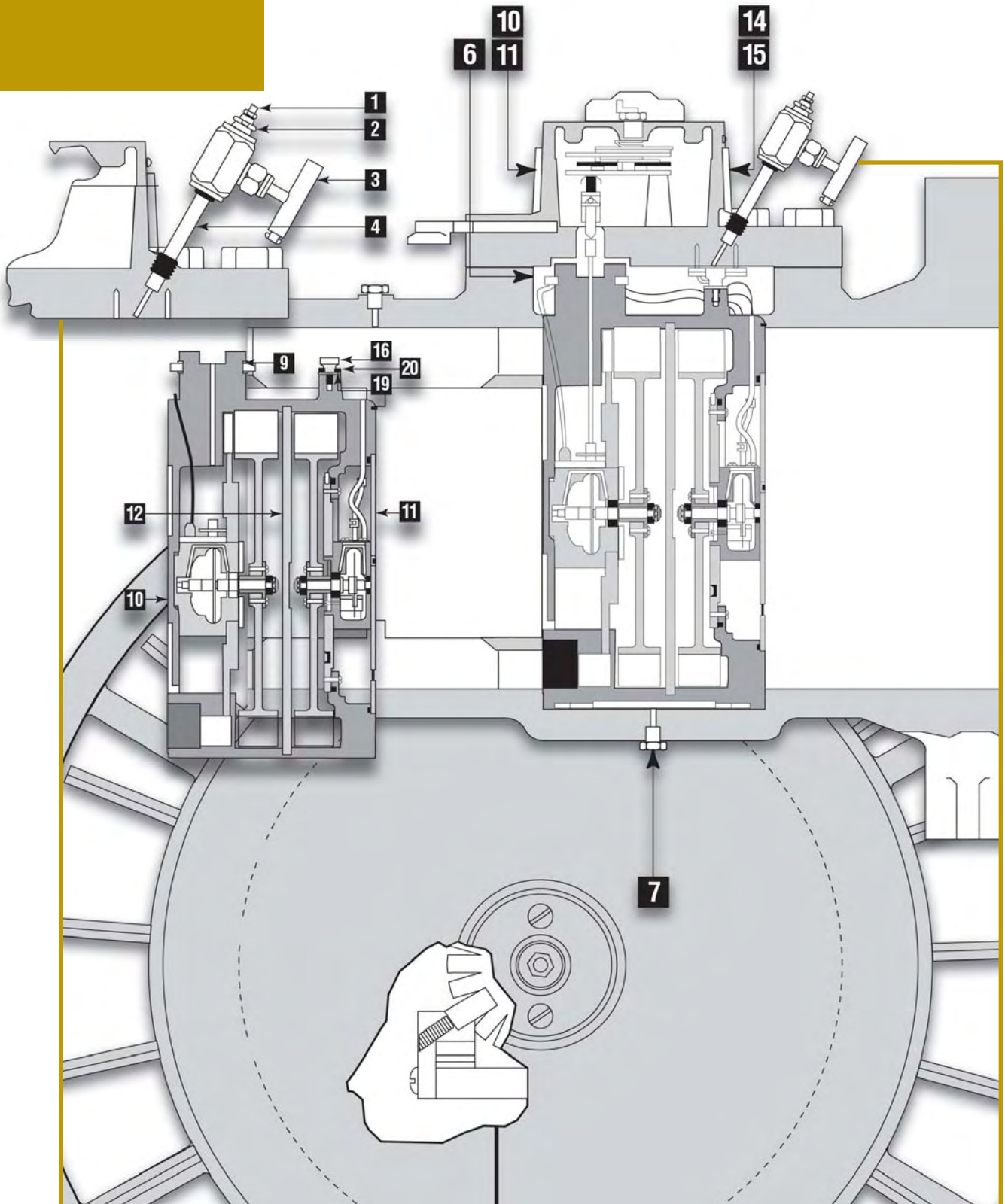

# Parts List

## 12" AAT-140 and AAT-230 Auto-Adjust® II Turbo-Meter

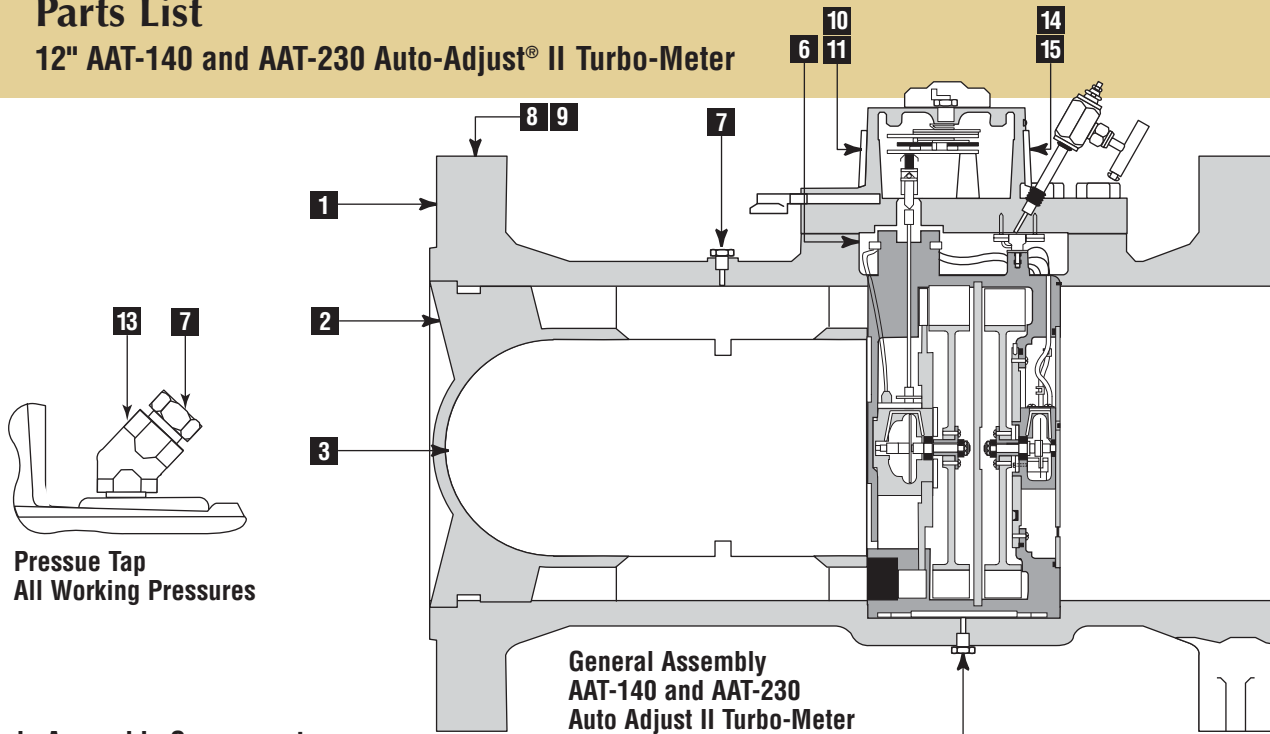

### Body Assembly Components

Illustration Number	Quantity Required	Part Description	Part Number
1	1	Main Body Assembly, 220#W.P. with Badges Less Nose Cone	006-31-611-00
		Main Body Assembly, Cast Steel, 720# W.P., ANSI 300 with Badges Less Nose Cone	006-31-611-50
		Main Body Assembly, Cast Steel, 1440# W.P., ANSI 600 with Badges Less Nose Cone	006-31-611-80
		Main Body Assembly, Cast Steel, 1440# W.P., ANSI 600 with Badges Less Nose Cone, with Ring Joint Flanges	006-31-611-81
2	1	Nose Cone with Straightening Vanes, All Pressures	006-31-305-01
3	3	#8-32 x 1/4" Long Set Screw	904713
4	1	Manufacturer Nameplate, 220# W.P. (not shown), AAT-140	006-31-073-01555
		Manufacturer Nameplate, 720# W.P. (not shown), AAT-140	006-31-073-50555
		Manufacturer Nameplate, 1440# W.P. (not shown), AAT-140	006-31-073-80555
		Manufacturer Nameplate, 220# W.P. (not shown), AAT-230	006-51-073-01555
		Manufacturer Nameplate, 720# W.P. (not shown), AAT-230	006-51-073-50555
5	4	Manufacturer Nameplate Screws (not shown)	903004
		#4 x 3/16" Long Round Head Drive Screw	
*6	1	Top Plate to Body "O" Ring, All Pressures, Buna	950192
*6A	1	Top Plate to Body "O" Ring, All Pressures, -20°F, Viton (optional)	950256 – 20°
			950773 – 40°
7	2	Steel Pipe Plug, 1/4" – 18	950179 – 40°
			906055 – 20°
8	1	Inlet Badge (on inlet flange of body)	015-16-090-02
9	2	#2 x 1/8" Round Head Brass Drive Screw	903003
10	1	Pulse Factor Badge (on top plate) Ft <sup>3</sup>	006-32-073-10
10A	1	Pulse Factor Badge (on top plate) M <sup>3</sup>	006-32-073-11
11	2	#8-32 x 1/4" Long Round Head Screw	903055
12	1	Internal Mechanism Badge (not shown), AAT-140	006-41-073-02555
		Internal Mechanism Badge (not shown), AAT-230	006-51-073-02555
13	1	45° Steel Elbow	950180 – 40°
			950762 – 20°
14	1	C.S.A. Approval Nameplate (not shown) AAT-140	006-41-074-00
		C.S.A. Approval Nameplate (not shown) AAT-230	006-51-074-00
15	4	C.S.A. Approval Nameplate Drive Screw (not shown)	903003

\*Recommended Spare Parts

## Parts List

### 12" AAT-140 and AAT-230 Auto-Adjust® II Turbo-Meter

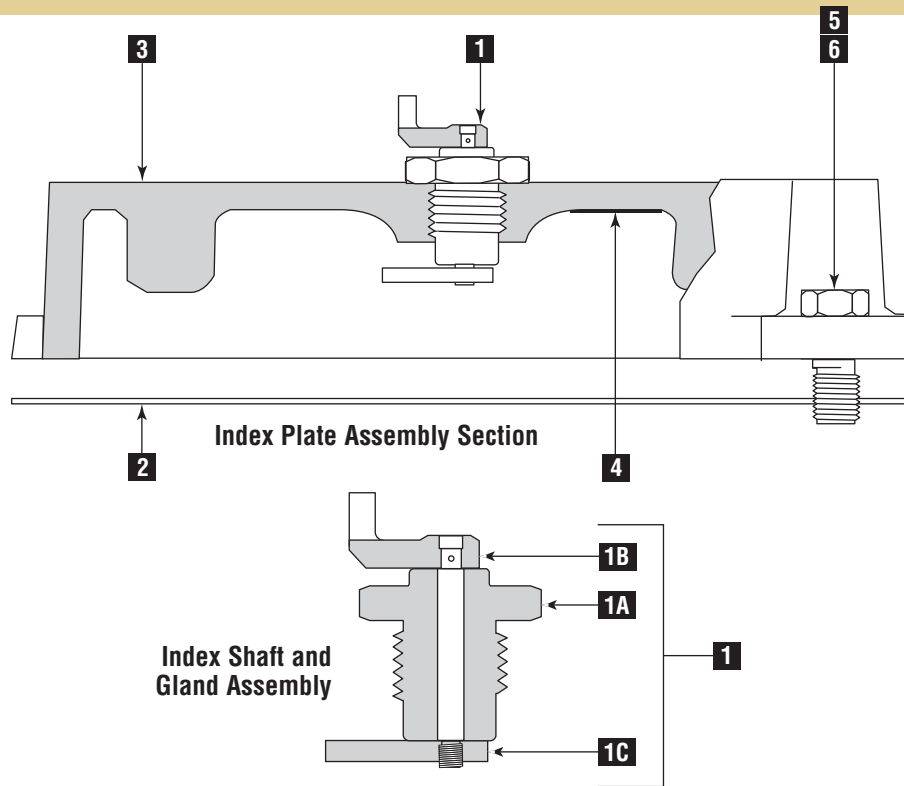

#### Index Plate Assembly Components

Illustration Number	Quantity Required	Part Description	Part Number
1	1	Index Shaft and Gland Assembly (Includes Illustration Nos. 1 A-C)	006-24-423-01
1A	1	Gland	006-24-023-01
1B	1	Index Shaft Assembly	006-24-554-02
1C	1	Bottom Dog	006-24-071-00
•2	1	Gasket, Index Plate to Top Plate	006-24-160-03
3	1	Index Plate	006-24-004-21
4	1	Wiring Label	006-32-105-00
5	3	Cap Screw, Index Plate to Top Plate, 5/16" - 18 x 3/4" Hex Head	910028
6	1	Seal Screw, Index Plate to Top Plate, 5/16" - 18 x 3/4" Hex Head	002-65-057-02

\*Recommended Spare Parts

# Parts List

## 12" AAT-140 and AAT-230 Auto-Adjust® II Turbo-Meter

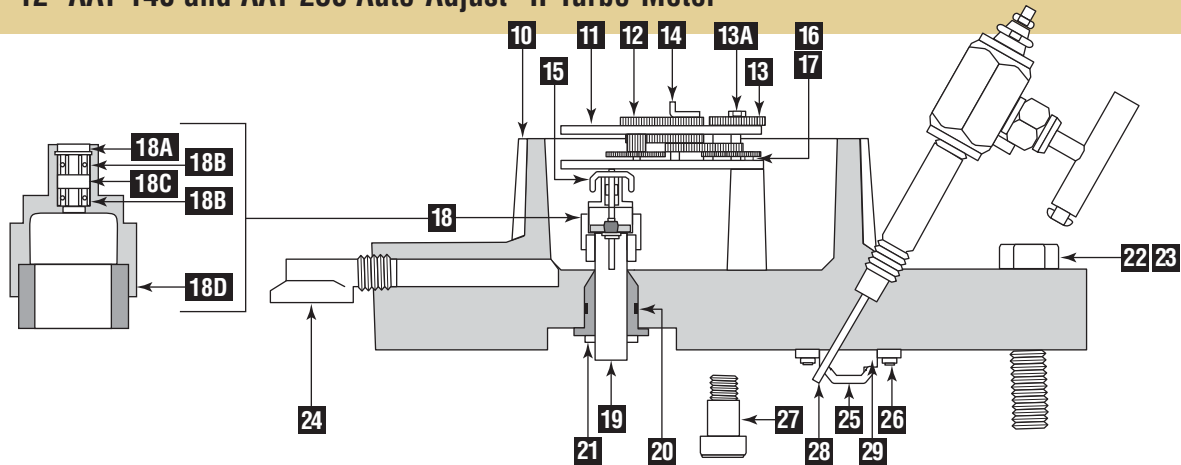

### Top Plate Assembly Components

Illustration Number	Quantity Required	Part Description	Part Number
10	1	Top Plate Assembly, 220# W.P. Ductile iron	006-41-303-00
		Top Plate Assembly, 720# W.P., Cast Steel	006-41-303-81
		Top Plate Assembly, 1440# W.P., Cast Steel	006-41-303-81
11	1	Intermediate Gear Assembly, 1000 CF/Rev., Plastic, Less Change Gears, AAT-140	006-34-212-40
		Intermediate Gear Assembly, 10 M <sup>3</sup> /Rev., Plastic, Less Change Gears, AAT-140	006-36-212-40
		Intermediate Gear Assembly, 1000 CF/Rev., Plastic, Less Change Gears, AAT-230	006-51-212-50
		Intermediate Gear Assembly, 10 M <sup>3</sup> /Rev., Plastic, Less Change Gears, AAT-230	006-51-212-00
12	1	Large Change Gear (note: "XX" refers to gear blank (diameter) size, "YY" refers to number of gear teeth. Digits must be substituted for "XX" and "YY" when ordering)	006-24-3XX-YY
13	1	Small Change Gear (see note for Illustration No. 12 above)	006-24-3XX-YY
13A	1	Small Change Gear Nut, #4-40 Hex Stainless Steel	907639
14	1	Intermediate Gear Output Dog (top)	002-66-071-03
15	1	Intermediate Gear Input Dog (bottom)	006-24-061-20
16	3	Intermediate Gear Retaining Screw, #8-32 x 3/8" Long Fillister Head	903371
17	3	Lockwasher	950371
* 18	1	Follower Magnet Assembly (Includes Illustration Nos. 18 A - C)	006-24-313-20
18A	1	Retaining Ring	904691
* 18B	2	Bearing	905462
18C	1	Spacer	006-24-106-20
18D	1	Follower Magnet Holder With Magnet	006-24-213-20
* 19	1	Magnet Well and Post Assembly, 220# W.P. (includes illustration no. 20)	006-31-244-00
		Magnet Well and Post Assembly, 720# & 1440# W.P. (Includes Illustration No. 20)	006-31-244-80
* 20	1	Magnet Well "O" Ring Buna	950193
		Magnet Well "O" Ring, Viton	908264
* 21	1	Magnet Well Tetraseal, Buna	904214
		Tetraseal, (optional) Viton	906736
22	13	Cap Screw, Top Plate to Body, 220# W.P., 5/8" - 11 x 2" Long Hex Head Stainless Steel	910159
		Cap Screw, Top Plate to Body, 720# & 1440# W.P., 1" - 8 x 2-3/4" Long Hex Head Steel	906540
23	1	Seal Screw, Top Plate to Body, 220# W.P., 5/8" - 11 x 2" Long Hex Head Stainless Steel	006-31-057-00
		Seal Screw, Top Plate to Body, 720# & 1440# W.P., 1" - 8 x 2-3/4" Long Hex Head Steel	006-31-057-80
24	2	Vent Cap	006-24-505-01
25	1	Extractor Bracket	00634-089-01
26	2	Extractor Bracket Retaining Screw, #8-32 x 3/8" Long Fillister Head	903371
27	2	Adapter Plate Screws	950780
28	1	Tubing for Oil System - Unformed	51911
29	1	Extractor Bracket Clip	00641-089-00

\*Recommended Spare Parts

## Parts List

### 12" AAT-140 and AAT-230 Auto-Adjust® II Turbo-Meter

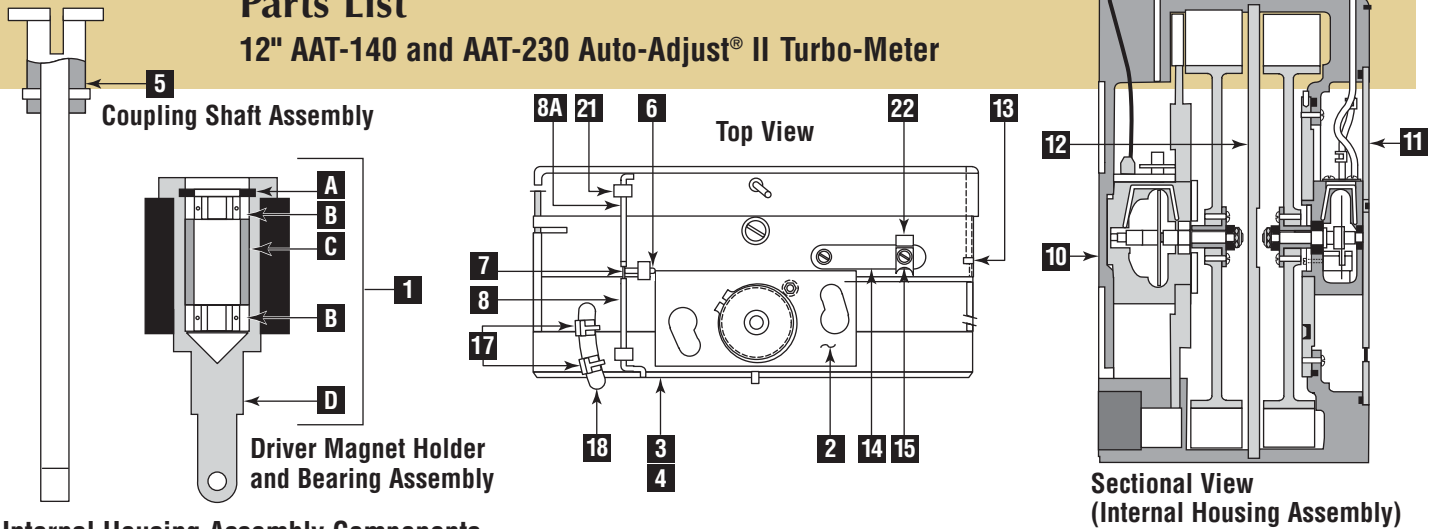

### Internal Housing Assembly Components

Illustration Number	Quantity Required	Part Description	Part Number
* 1	1	Driver Magnet Holder and Bearing Assembly (includes illustration nos. 1 A-D)	006-31-334-00
1A	1	Bearing Retaining Ring	904691
* 1B	2	Bearing	905462
1C	1	Spacer	006-22-106-03
1D	1	Magnet, Holder & Pin Assembly	006-31-234-02
2	1	Adapter Plate Quick Connect	006-41-062-00
3	1	Internal Housing Assembly, Calibrated With Change Gears, Cubic Foot, AAT-140	006-41-302-01
4	1	Internal Housing Assembly, Calibrated With Change Gears, Metric, AAT-140	006-41-302-02
3	1	Internal Housing Assembly, Calibrated With Change Gears, Cubic Foot, AAT-230	006-51-302-01
4	1	Internal Housing Assembly, Calibrated With Change Gears, Metric, AAT-230	006-51-302-02
5	1	Coupling Shaft Assembly, 220# W.P.	006-41-345-00
		Coupling Shaft Assembly, 720# and 1440# W.P.	006-41-345-80
6	1	Oil Tubing, Top Plate to Internal Housing	99993
7	1	Tee	950247
8	1	Oil Tubing, Tee to Metering Rotor Module	99993
8A	1	Oil Tubing, Tee to Sensor Rotor Module	99993
9	1	Retaining Ring	927448
** 10	1	Main (metering) Rotor Assembly, AAT-140, Buna	006-41-550-02
		Main (metering) Rotor Assembly, AAT-140, Viton	006-41-550-90
		Main (metering) Rotor Assembly, AAT-230, Buna	006-51-550-00
		Main (metering) Rotor Assembly, AAT-230, Viton	006-51-550-01
** 11	1	Sensing Rotor Assembly, AAT-140, Buna	006-41-550-03
		Sensing Rotor Assembly, AAT-140, Viton	006-41-550-91
		Sensing Rotor Assembly, AAT-230, Buna	006-51-550-03
		Sensing Rotor Assembly, AAT-230, Viton	006-51-550-91
** 12	1	Center Plate, AAT-140	006-41-109-01
		Center Plate, AAT-230	006-51-109-01
13	2	Module Connecting Screw, #10-24 x 3/4" Long Screw Note: Maximum Torque = 10 Inch/Lb.	950384
14	1	Serial Number Badge	006-34-073-01
15	2	Serial Number Badge Retaining Screw, #4-40 x 1/4" Long Pan Head Screw	950380
16	1	Shoulder Screw	950319
17	2	Compression Ring (Pressure Line)	950772
18	5"	Pressure Tap Tubing	800700
19	1	"O" Ring, Buna-N	934005
		"O" Ring, Viton (Optional)	904839
20	1	Disc Spring	950749
21	3	Compression Ring (Oil)	950682
22	1	Wire Clip	950517
23		Extractor Bracket Retrofit Kit (not shown)	006-41-190-00
24		Oil Tube Replacement Assembly (not shown) (includes 6, 7, 8, 8A & 21)	006-41-325-00

\*Recommended Spare Parts

\*\*Illustration numbers 10, 11 and 12 affect calibration. These components must be ordered in combination and cannot be supplied as separate items.

## Parts List

12" AAT-140 and AAT-230 Auto-Adjust® II Turbo-Meter

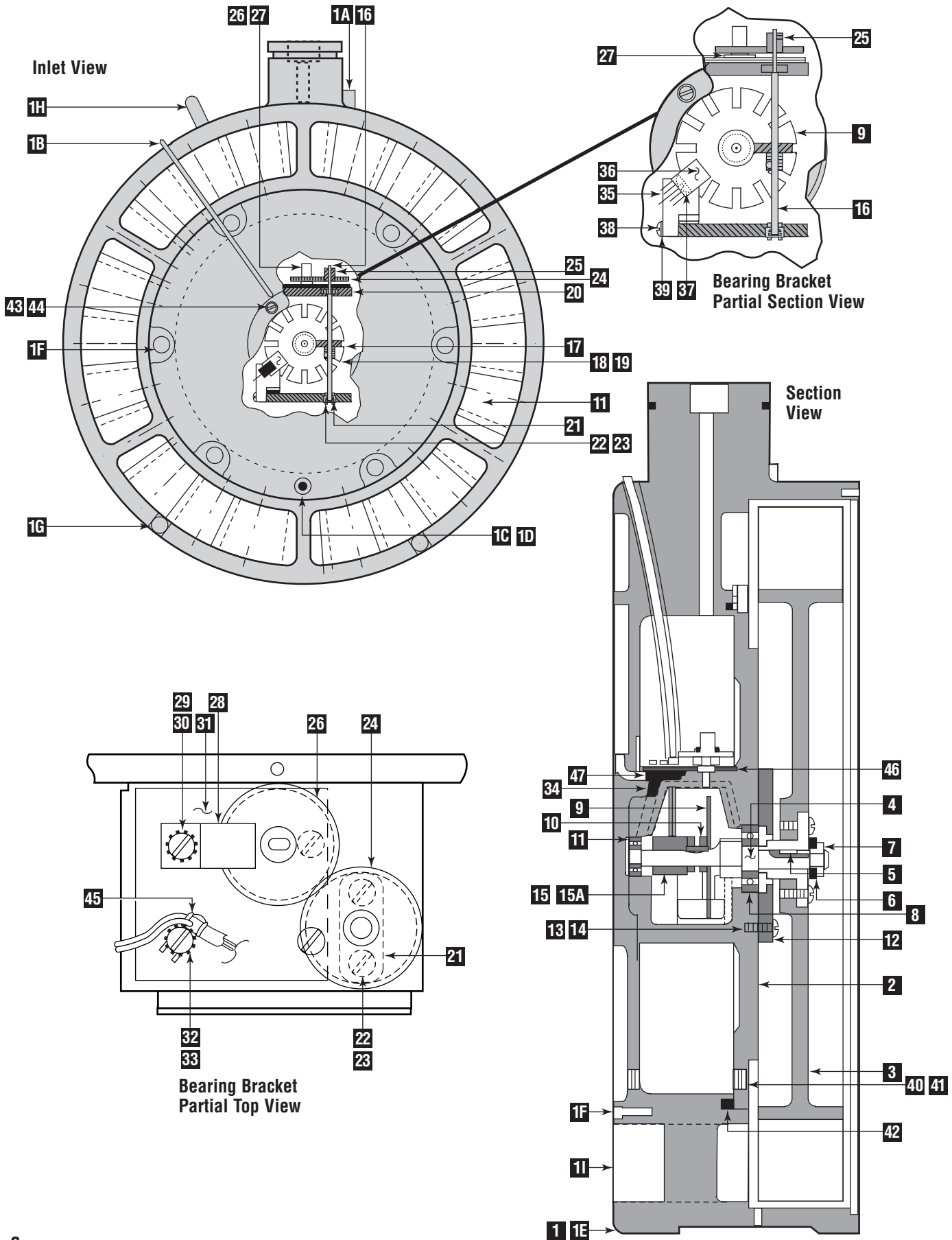

Illustration Number	Quantity Required	Part Description	Part Number
**	1	Main Rotor Assembly, AAT-140, Buna	006-41-550-02
		Main Rotor Assembly, AAT-140, Viton	006-41-550-90
		Main Rotor Assembly, AAT-230, Buna	006-51-550-00
		Main Rotor Assembly, AAT-230, Viton	006-51-550-01
** 1	1	Carrier Assembly (Includes Illustration Nos. 1 A-E)	006-41-519-03
1A	1	Dowel Pin	950214
1B	1	Oil Tubing	006-41-079-00
1C	2	Filter Screen	006-22-083-01
1D	2	Screen Retainer	904419
** 1E	1	Bearing Bracket Carrier	006-41-019-04
1F	6	#6-32 1/4" Long Pan Head Screw	950585
1G	4	Module Seal Positioner	950756
1H	1	Pressure Tap Tube, 3/16"	006-34-079-02
1I	6	Vane Insert	006-41-025-00
2	1	Bearing Bracket	006-41-209-00
** 3	1	Rotor and Insert Assembly, AAT-140	006-41-350-00
		Rotor and Insert Assembly, AAT-230	006-51-350-00
4	1	Main Rotor Shaft	006-41-024-00
5	1	Locking Key (rotor to shaft)	006-24-069-00
6	1	Spherical Washer	908723
7	1	Locknut	908661
* 8	1	Downstream Rotor Shaft Bearing	950311
9	1	Chopper Disc Assembly	006-41-308-00
10	1	Retaining Screw, Chopper Disc to Shaft, #4-40 x 1/8" Long Set Screw	950305
* 11	1	Upstream Rotor Shaft Bearing	950306
12	1	Downstream Bearing Retainer Plate	006-41-018-00
13	3	Retainer Plate Screw, #8-32 x 7/16" Long Round Head Screw	903058
14	3	Retainer Plate Screw Lockwasher	950371
15	1	Worm	006-41-017-00
15A	2	Retaining Screw, Worm to Shaft, #6-32 x 1/8" Long Set Screw	950375
16	1	Wormwheel Shaft	006-31-046-00
17	1	Wormwheel (15T)	006-24-035-00
18	1	Wormwheel Hub	006-24-070-02
19	2	Wormwheel Hub Set Screw #6-32 x 1/8" Long Set Screw	950375
* 20	2	Wormwheel Shaft Bearing	908660
21	2	Bearing Retainer Plate	006-22-117-01
22	4	Retainer Plate Screw #4-40 x 1/4" Long Pan Head Screw	950380
23	4	Lockwasher	950078
24	1	44T Idler Gear	006-31-344-44
25	1	Idler Gear Set Screw #6-32 x 1/8" Long Set Screw	950375
26	1	44T Drive Gear	006-36-444-44
27	1	Drive Gear Post	006-31-028-00
28	1	44T Drive Gear Retainer	006-24-080-00
29	1	Drive Gear Retainer Screw, #4-40 x 1/4" Long Pan Head Screw	950380
30	1	Retainer Screw Lockwasher	950078
31	1	Oil Reservoir Cover	006-41-053-01
32	3	Reservoir Cover Screw #4-40 x 1/4" Long Pan Head Screw	950380
33	3	Cover Screw Lockwasher	950078
34		Oil Wick	1191430
35	1	Slot Sensor Holder	006-41-078-00
36	1	Slot Sensor Switch	950237
37	1	#0-80 x 5/16" Long Flat Head Screw	950238
38	2	#5-40 x 1/2" Long Round Head Screw	950307
39	2	Lockwasher	950374
40	1	Bearing Bracket Filter Screen	006-22-083-01
41	1	Filter Screen Retainer	904419
* 42	1	Bracket to Carrier Tetraseal, Buna	950308
		Bracket to Carrier Tetraseal, Viton	950523
43	4	Bracket Retaining Screw #8-32 x 1/2" Long Fillister Head Screw	903373
44	4	Bracket Retaining Screw External Lockwasher	950371
45	1	Wire Clamp	950407
46	1	Oil Reservoir Gasket	006-41-160-01
47	1	Seal, Oil Passage, Buna	006-36-160-09
		Seal, Oil Passage, Viton	908289

\*Recommended Spare Parts

\*\*These items affect calibration. These components must be ordered in combination and cannot be supplied as separate items.

## Parts List

12" AAT-140 and AAT-230 Auto-Adjust® II Turbo-Meter

### Sensing Rotor Assembly Components

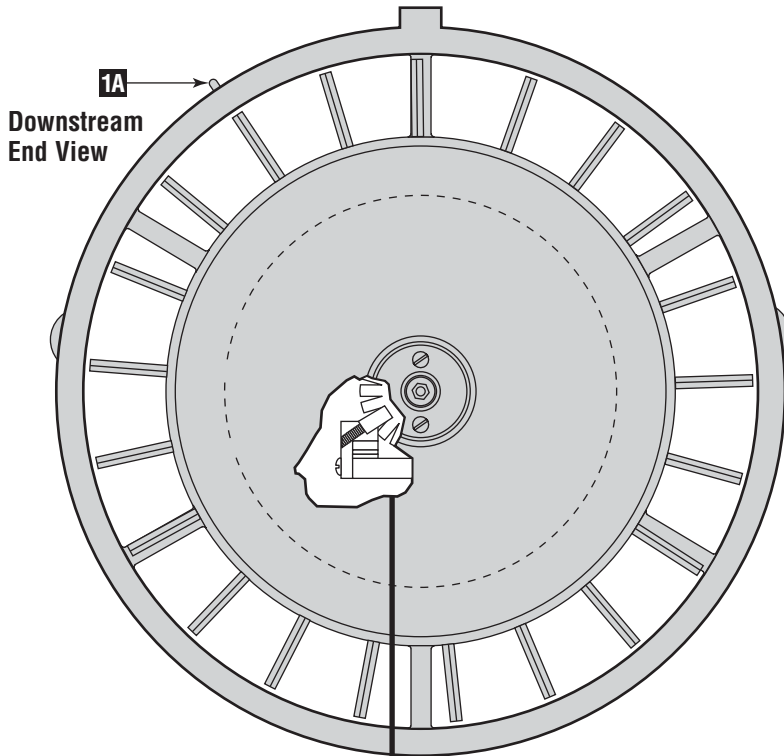

**Partial Bearing Bracket Section View**

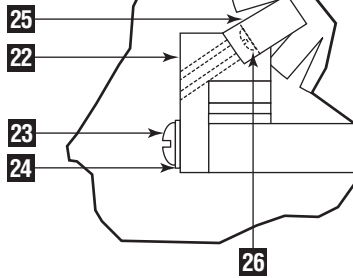

**Partial Bearing Bracket Top View**

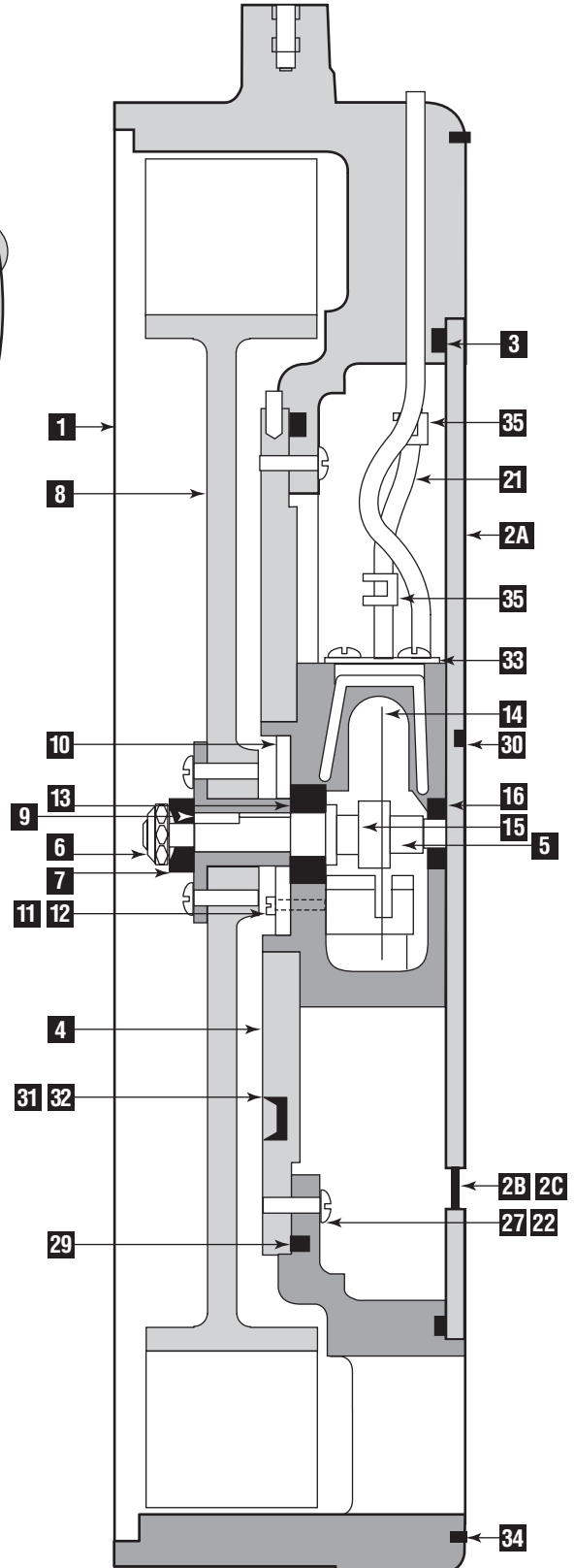
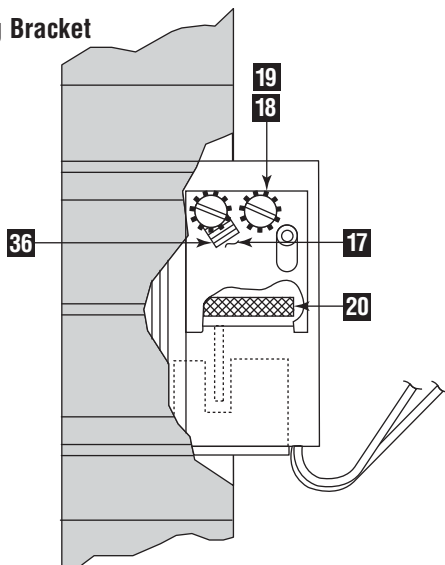

**Side View Section**



## Parts List

### 12" AAT-140 and AAT-230 Auto-Adjust® II Turbo-Meter

#### Sensing Rotor Assembly Components

Illustration Number	Quantity Required	Part Description	Part Number
**	1	Sensing Rotor Assembly, AAT-140, Buna	006-41-55003
		Sensing Rotor Assembly, AAT-140, Viton	006-41-55091
		Sensing Rotor Assembly, AAT-230, Buna	006-51-55002
		Sensing Rotor Assembly, AAT-230, Viton	006-51-55090
**1	1	Carrier Assembly (Includes Illustration No. 1A)	006-41-51902
1A	1	Oil Tubing	006-41-07901
2	1	Housing Plate Assembly, (Includes Illustration Nos. 2 A-C)	006-41-21000
2A	1	Housing Plate	006-41-01000
2B	1	Filter Screen	006-22-08301
2C	1	Screen Retainer	904419
*3	1	Tetraseal, Buna	950308
		Tetraseal, Viton	950523
4	1	Bearing Bracket	006-41-20901
5	1	Rotor Shaft	006-41-02401
6	1	Locknut	908661
7	1	Spherical Washer	908723
**8	1	Rotor and Insert Assembly, AAT-140	006-41-35001
		Rotor and Insert Assembly, AAT-230	006-51-35001
9	1	Rotor Locking Key	006-24-06900
10	1	Upstream Bearing Retainer Plate	006-31-11700
11	2	#4-40 x 3/8" Long Fillister Head Screw	903340
12	2	#4 Lockwasher	950078
*13	1	Upstream Rotor Shaft Bearing	906019
14	1	Chopper Disc Assembly (18 blades)	006-41-30802
15	1	#4-40 x 1/8" Long Set Screw	950305
*16	1	Downstream Rotor Shaft Bearing	950306
17	1	Oil Reservoir Cover Assembly	006-41-25300
18	4	#4-40 x 1/4" Long Pan Head Screw	950380
19	4	Lockwasher	950078
20		Oil Wick	1191430
21		Tubing	99993
22	1	Slot Sensor Holder	006-41-07800
23	2	Holder Retaining Screw #5-40 x 1/2" Long Round Head Screw	950307
24	2	Lockwasher	950374
25	1	Slot Sensor Switch	950563
26	1	Switch Retainer Screw # 0-80 x 5/16" Long Screw	950238
27	4	Carrier to Bracket Screw #8-32 x 1/2" Long Round Head Screw	908722
28	4	Lockwasher	950371
*29	1	Tetraseal, Buna	950310
		Tetraseal, Viton	950524
30	4	Bracket Retaining #8-32 x 3/8" Long Flat Head Screw	903132
31	2	Filter Screen	006-22-08301
32	2	Screen Retainer	904419
33	1	Oil Reservoir Gasket	006-41-16000
34	1	Square Rope (Held in w/Bostik Adhesive 4585 P/N 905120)	006-41-16400
35	2	Compression Ring	950682
36	1	Wire Clamp	950407
		Oil 4 ounce Bottle	006-22-40501
		Oil, 1 Gallon Can	006-22-40502
		Lubrication Hand Gun	006-24-40000
		Blank Top Plate, 220# W.P.	006-31-00304
		Blank Top Plate, 720# & 1440# W.P.	006-31-00382

\*Recommended Spare Parts

\*\*These items affect calibration. These components must be ordered in combination and cannot be supplied as separate items.

# Parts List

## 12" AAT-140 and AAT-230 Auto-Adjust® II Turbo-Meter

### External Lubrication Systems Fittings

Illustration Number	Quantity Required	Part Description	Part Number
1	1	Lubrication Fitting	000624-14500
2	1	Hex Bushing	950195
3	1	Valve 1/4"	950147 – 40°
			950710 – 20°
4	1	Pipe Nipple	950186 – 40°
			950760 – 20°

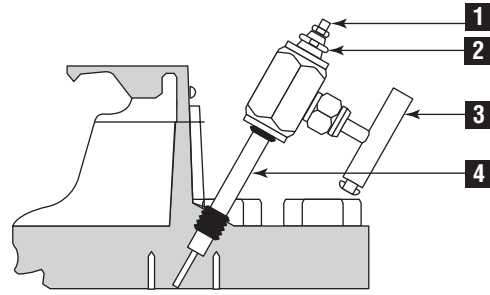

### Electrical Systems Fittings

Illustration Number	Quantity Required	Part Description	Part Number
1	1	Terminal Block	950364
2	3	#8-32 x 3/8" Long Screw	903371
3	A/R	Loctite	905115
4	1	#8-32 x 3/8" Long Screw	903371
4A	1	Washer	950448
5	2	"O" Ring, Buna	946861
5A	2	"O" Ring, Viton	902418
6	1	Feed-Thru Assembly, Buna	00632-31701 – 40°
			006-32-31700 – 20°
6A	1	Feed-Thru Assembly, Viton	750155
			800633
7	A/R	Solder	950371
8	A/R	Shrink Tube	
9	1	Lockwasher	

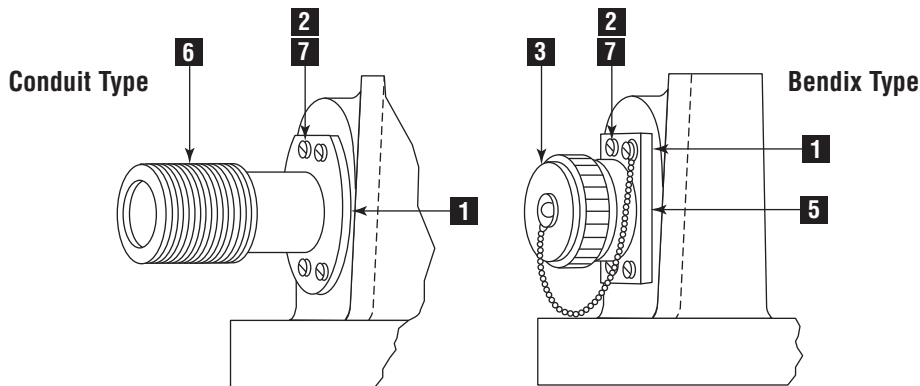
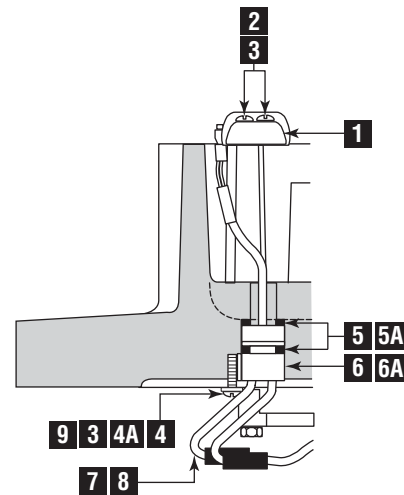

### External Wiring Fittings

Illustration Number	Quantity Required	Part Description	Part Number
1	1	Gasket	905321
2	4	#8-32 x 1/4" Long Round Head Screw	903055
3	1	Cap and Chain Assembly for Bendix Connector	006-32-13100
4	1	Bendix Connector, Female End (not shown)	950388
5	1	Bendix Connector, with Wiring to Terminal Block	006-34-25000
6	1	Conduit Adapter Assembly with Wiring to Terminal Block	006-34-33000
7	4	Lockwasher	950371

## Parts List

12" AAT-140 and AAT-230 Auto-Adjust® II Turbo-Meter

### Wiring System Components

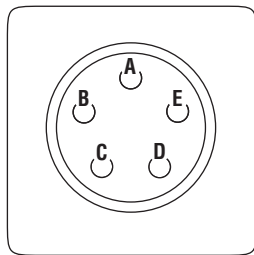
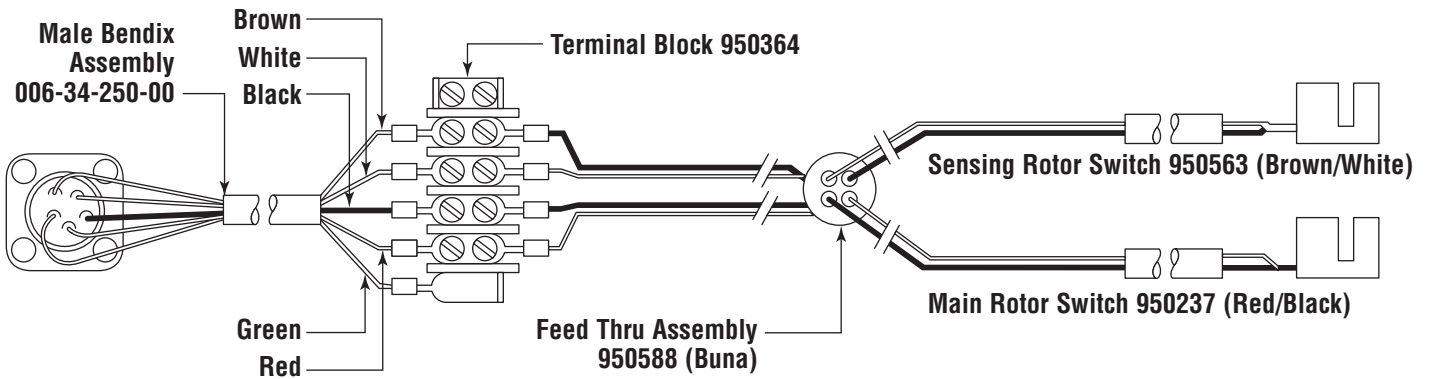

Bendix Connector  
Male End

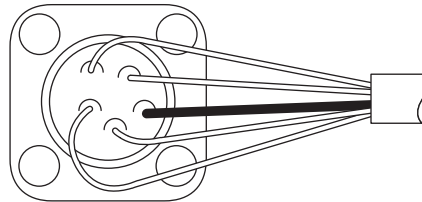

Male Bendix Cable Assembly  
006-34-250-00  
or Conduit Adapter Assembly (not shown)  
006-34-330-00

### Terminal Block Wiring Detail for Bendix or Conduit Connectors

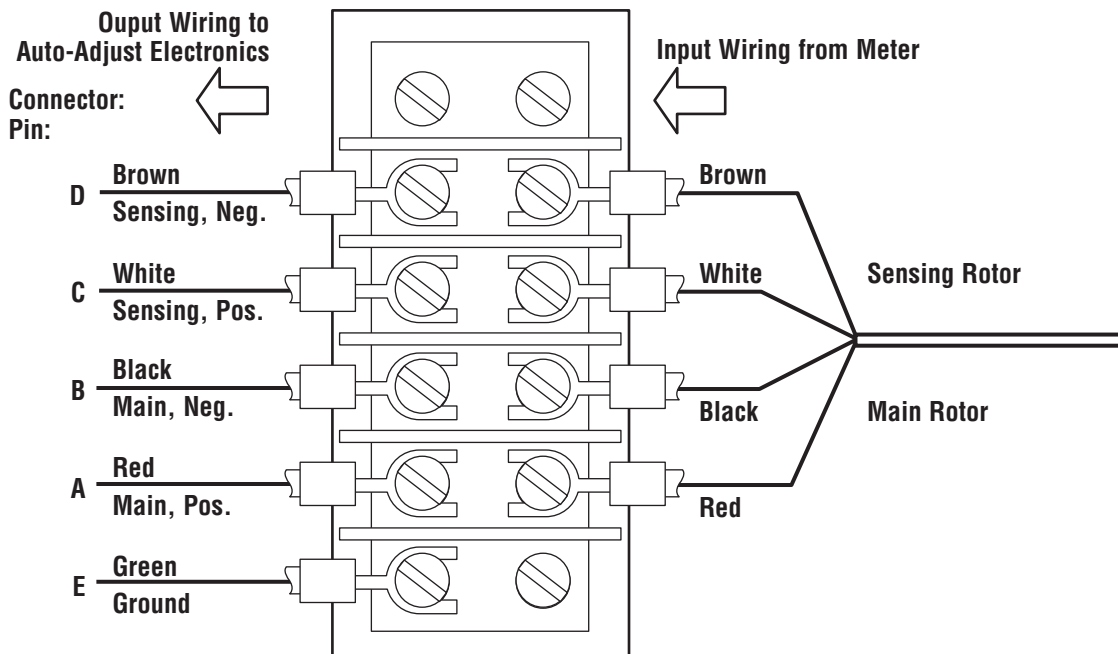



805 Liberty Boulevard  
DuBois, PA 15801  
800-375-8875  
Fax: (814) 375-8460  
[www.sensus.com](http://www.sensus.com)  
(North American Gas)

**Representatives  
in all principal cities.**

**Distributors  
throughout the world.**

## **Authorized Distributor:**

All products purchased and services performed are subject to Sensus' terms of sale, available at either; <http://na.sensus.com/TC/TermsConditions.pdf> or 1-800-METER-IT. Sensus reserves the right to modify these terms and conditions in its own discretion without notice to the customer.

This document is for informational purposes only, and SENSUS MAKES NO EXPRESS WARRANTIES IN THIS DOCUMENT. FURTHERMORE, THERE ARE NO IMPLIED WARRANTIES, INCLUDING WITHOUT LIMITATION, WARRANTIES AS TO FITNESS FOR A PARTICULAR PURPOSE AND MERCHANTABILITY. ANY USE OF THE PRODUCTS THAT IS NOT SPECIFICALLY PERMITTED HEREIN IS PROHIBITED.